

DIMENSIONS

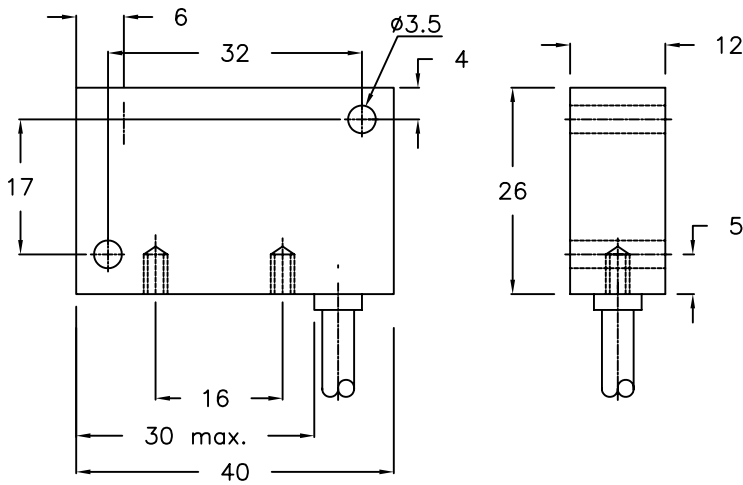

WIRING DIAGRAM

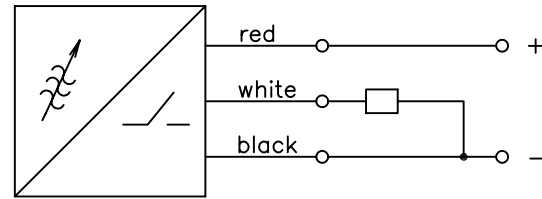

MOUNTING DETAILS

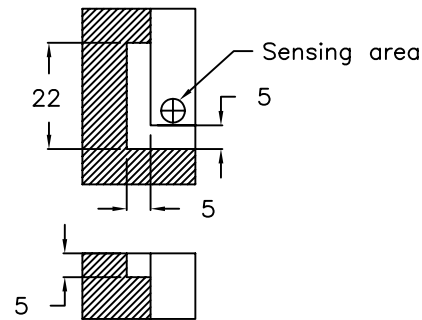

SPECIFICATIONS:

Supply Voltage	: 5-30 VDC
Output Logic	: PNP, N/O
Operating Distance	: 4 ± 0.4 mm
Hysteresis	: <10%
Repetition Rate	: 250 Hz
Repeatability	: 0.2 mm
Maximum Load Current	: 100 mA
Current Consumption	: <15 mA
Voltage Drop	: <2.2 V @ max. rated current
Residual Voltage	: <0.8 V
Operating Temperature	: -25°C to +75°C
Mounting	: Non-flush
Standard Target	: 12x12x1 mm Plate
Function Indication	: LED
Protection	: Short Ckt & Polarity reversal
Housing	: Plastic, Colour - Orange
Connection	: 3 x 0.24 sq mm , length 1.5m

Revised on	Sign
15/09/03	